

FONDAPLY-2

DEFINITION

FONDAPLY-2 is a SBS self adhesive bituminous membrane for damp proof courses.

SCOPE OF APPLICATION

Membrane for a single layer waterproofing system of underground walls.

Applied upon : Waterproofing of buried walls.
Applied by : Self adhesive.



DESCRIPTION

Surface	Synthetic film
Blend	Adhesive bitumen
Reinforcement	Synthetic film
Bottom surface	Removable film

DIMENSIONAL CHARACTERISTICS

	Nominal value	Critical value
Thickness at the selvedge (mm)	1.5	1.4
Length (m)	20	19.80
Width (m)	1	0.99
Weight of a roll (kg)	29.7	29.1
Weight/m ² (kg)	1.47	1.39

PERFORMANCES

	Norm	Unit	Nominal values	Critical values
Tensile strength	EN 12311-1	N/5cm	170 x 170	170 x 170
Elongation	EN 12311-1	%	18 x 18	18 x 18
Nail tearing resistance	EN 12310-1	N	85 x 85	85 x 85
Cold bending resistance	EN 1109	°C	-15	-15
Shear joint resistance (side lap x head lap)	EN 12317-1	N/50mm	200 x 200	-
Static puncture resistance (hard substrate)	EN 12730 B	kg	20	-
Resistance to impact (hard substrate)	EN 12691 A	mm	200	-
Waterproofing	EN 1928	-	Pass	-
Vapour resistance	EN 1931	m ² .s.Pa/kg	1.5 E +13	-

ISO 9001 REFERENCE DOCUMENT

Our company has been awarded the ISO 9001 certificate for all its establishments in France.
Our company reserves the right to modify this document as a result of technological and experimental improvements.

To obtain the up-date technical data sheet, please contact Siplast

100908 Spc v6



PACKAGING

Rolls quantity per truck pallet	20
Rolls quantity per container pallet	25
Rolls quantity per wooden box	-

GENERALITIES ABOUT APPLICATION

Application	This product can only be applied on supports, which are clean, dry, free of grease, brushed and without aggressive asperities. The support must be primed with one layer of ADEPRIMAIRE or one layer of SIPLAST PRIMER (or IMPRESION VERAL) 0,3lt/m ³ . On metallic support the primer application is advised but not imperative, the surface shall be free of oxidation. When the primed surface is dry and the silicone film removed, the bitumen under-face must be lightly heated if the temperature is below 15°C ; then the product is carefully rolled and pressed into place with a rubber roller. Apply aluminium flashing protection Bande Solin 72 . Apply a Fonda+, or Fonda GTX or Prim'Nap HDPE embossed protection layer.
Overlaps	Current building practices concerning overlaps is 100 mm.
Slopes	When applied with slope $\geq 15\%$, this product must be fixed by 4 mechanical fixings on head, in complement when the slope is $\geq 100\%$ the length is reduced to 3m.

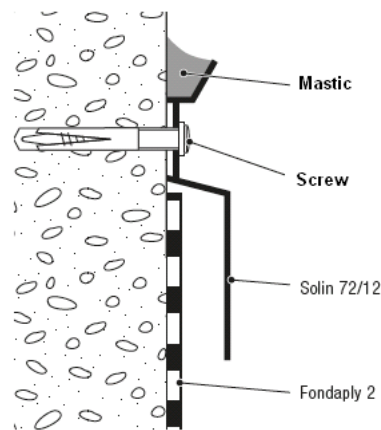
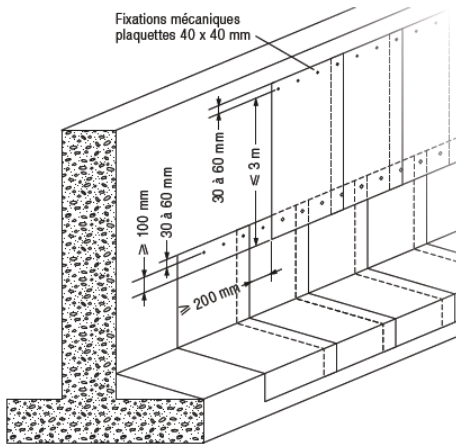

COMPLEMENTARY INFORMATIONS

Product identification	
Values	Where 2 values for given characteristics are shown, the first is for longitudinal direction and the second is for the cross direction.
Tolerances	The average values derived from standard tests and are subject to the usual production variations. The indicated average values comply with the UEAtc and EN standard. The nominal value tolerances comply with the UEAtc standards. Some slight variations can be noticed as the values are based on the average values obtained from several plants.
Hazardous classification	It is not classified as dangerous according to the international regulation (ADR, RID, IATA, et RTMDR)
Divers	This product is only a product technical data sheet, regarding each waterproofing design, please, consult the concerned technical agreement and in case of doubt contact our technical department.
Storage	This product is packaged in rolls set up vertically on pallet or wooden box. It must be stored vertically under shelter, away from heat sources.