

Fonda +/-Fonda GTX

Studded membranes for protection and drainage of below-grade walls



- ▶ High resistance to compression due to the octagonal shape of studs
- ▶ 25% contact area on basement walls and other foundations structures
- ▶ Quick and simple to apply under all weather conditions; easy to cut with a cutter
- ▶ Range of accessories suitable for different substrates

Main uses

- Protection and vertical drainage of exterior basement walls.
- Vertical drainage of structural below-grade walls.
- Geo-spacer with or without filter geotextile to be applied in all civil works, e.g.:
 - ▶ bridge abutments;
 - ▶ tunnels intrados;
 - ▶ cut and cover trenches;
 - ▶ drainage system for bottom of reservoir ;
 - ▶ drainage of water infiltration and insulation against moisture inside buildings (curative treatment).

Packaging

- **Fonda +/-**: rolls in 1m, 1.50m, 2m or 2,50m wide and 20m long.
- **Fonda GTX**: rolls in 2m x 15m.

Accessories

- **Fonda finishing profile** in HDPE. 2m long: per unit.
- **Fonda finishing profile** in PVC. 2m long: per unit.
- **Fonda nails and plugs for bricks and concrete blocks**: 100 units per box.
- **Fonda gun plugs for concrete**: 200 units per pack.
- **Fonda pipe collar Ø 75mm**: per unit (10 units/box).
- **Fonda pipe collar Ø 110mm**: per unit (10 units/box).
- **Fonda jointing tape in butyl**: 50mm x 10m (w x L): per unit (6 units/box).
- **Ademas mastic**: per unit (12 cartridges/cardboard).

Fonda +/-Fonda GTX

Studded membranes for protection and drainage of below-grade walls

Fonda +

Protection board in HDPE with octagonal studs for below-grade walls and underground structures

Description

- HDPE embossed membrane shaped with octagonal studs.

Substrate

- Below-grade concrete or masonry walls fitted with or without waterproofing layer.

Application

- Fonda + is horizontally unrolled with studs against the wall and mechanically fixed along the upper edge:
 - ▶ when applied to concrete, use Fonda gun plugs and nails ("Hilti" type, 20 to 27mm gun nails).
 - ▶ when applied to masonry, use Fonda nails and plugs for concrete blocks and bricks.



- When the height of the relevant wall is over the width of a Fonda + roll, the upper roll will overlap the lower roll (horizontal overlaps of about 12cm).
- Vertical overlaps must be about 50cm wide.
- The Fonda finishing profile is fixed on the top edge.
- The backfilling is completed according to the prevailing local technical standards.

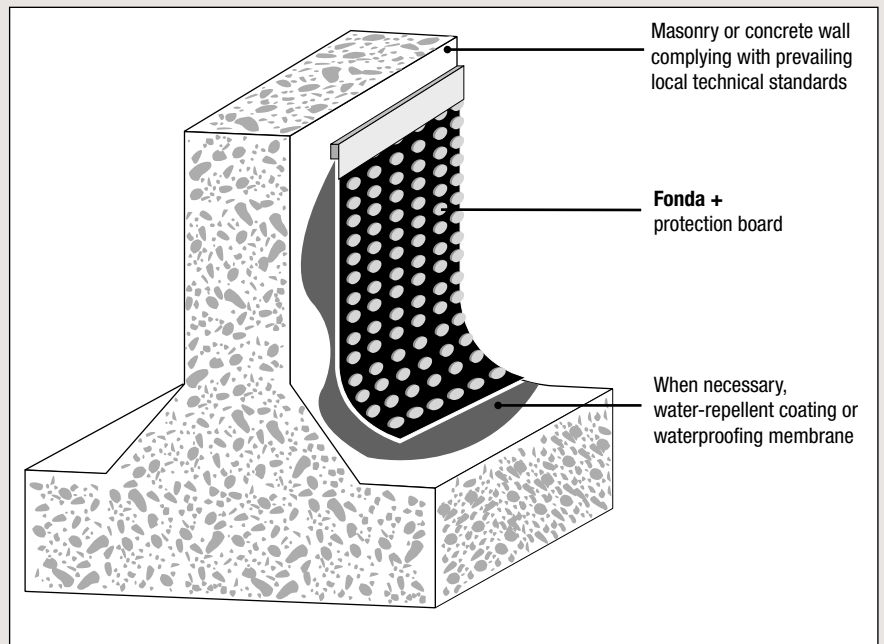

Fonda GTX

Protection and drainage board surfaced with a drainage geotextile for below-grade walls and underground structures.

Description

- Polypropylene embossed membrane + thermo-welded filtering non woven polypropylene geotextile.

Substrate

- Below-grade concrete or masonry walls fitted with or without waterproofing layer.

Application

- Fonda GTX is horizontally unrolled with the geotextile against the wall and mechanically-fixed along the upper edge:
 - ▶ when applied to concrete, use Fonda gun plugs and nails ("Hilti" type, 20 to 27mm gun nails);
 - ▶ when applied to masonry, use Fonda nails and plugs for concrete blocks and bricks.
- When the height of the relevant wall is over 2m, the Fonda GTX upper roll will overlap the lower roll (horizontal overlaps of about 12cm).
- Vertical overlaps must be about 50cm wide.
- The Fonda finishing profile is fixed on the top edge.
- Fonda GTX must be linked at its bottom edge with a drainage peripheral pipe.
- The backfilling is completed according to the prevailing local technical standards.

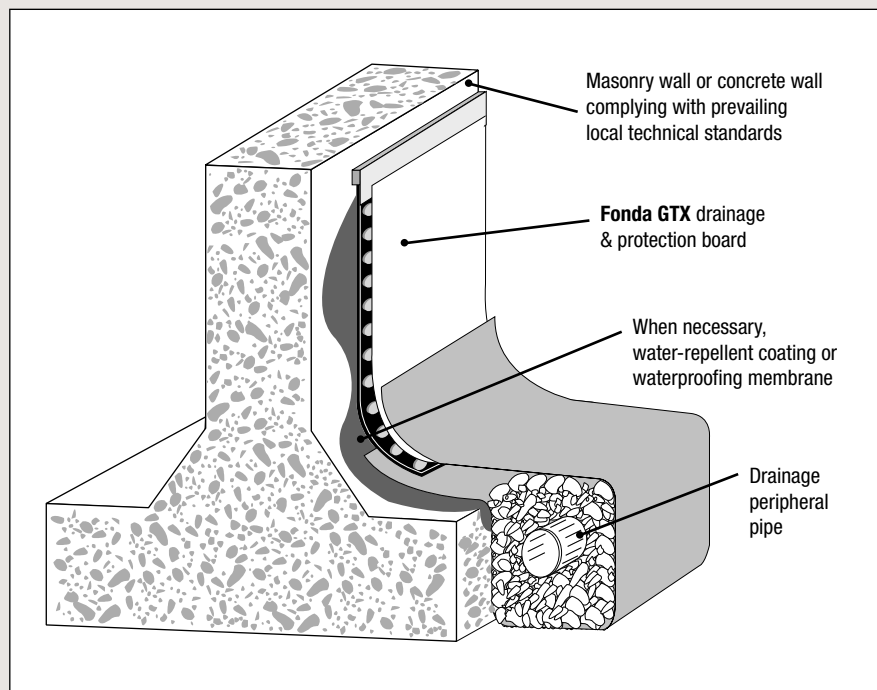

Fonda +/-Fonda GTX

Studded membranes for protection and drainage of below-grade walls

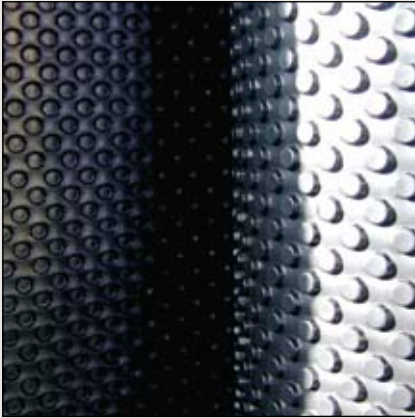

Fonda +



Fonda GTX

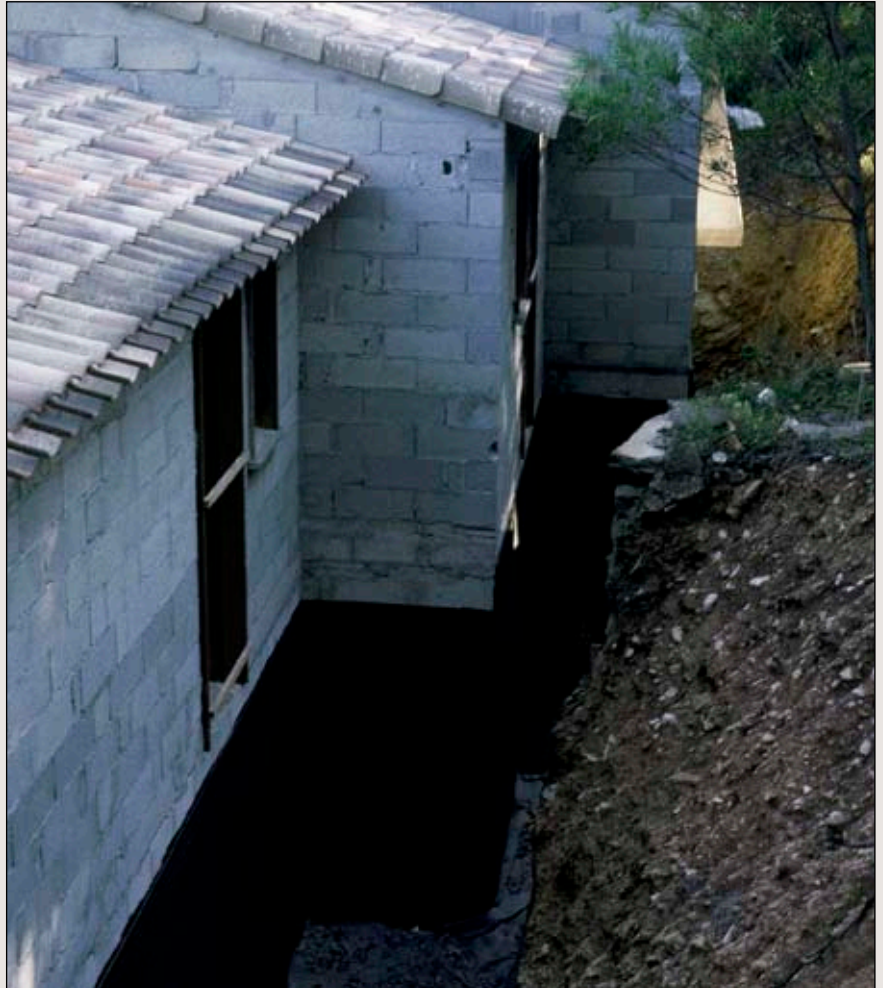

Complementary information

- **Fonda** Protection n° 7/04-1369 French Technical Agrément.
- **Fonda +** technical data sheet.
- **Fonda GTX** technical data sheet.

Customs nomenclature

39 07 91 90 90 00 Q

Safety

Fonda + and **Fonda GTX** are not rated dangerous (for the applications described in this document).

This document is only a guide. Siplast-Icopal reserves the right to change the composition and fixing recommendations of products as a result of evolution of knowledge and technology.



12, rue de la Renaissance
F-92184 Antony Cedex
Tél. +33 (0)1 40 96 35 00
Fax. +33 (0)1 46 66 24 85
www.siplast-international.com

ISO 9001
BUREAU VERITAS
Certification



L'ensemble des sites de la Société